



Table for Coahoma County showing well numbers, depths to water below land for years 2001, 2006, 2010, and 2011, and total change.



Table for Coahoma County showing well numbers, depths to water below land for years 2001, 2006, 2010, and 2011, and total change.

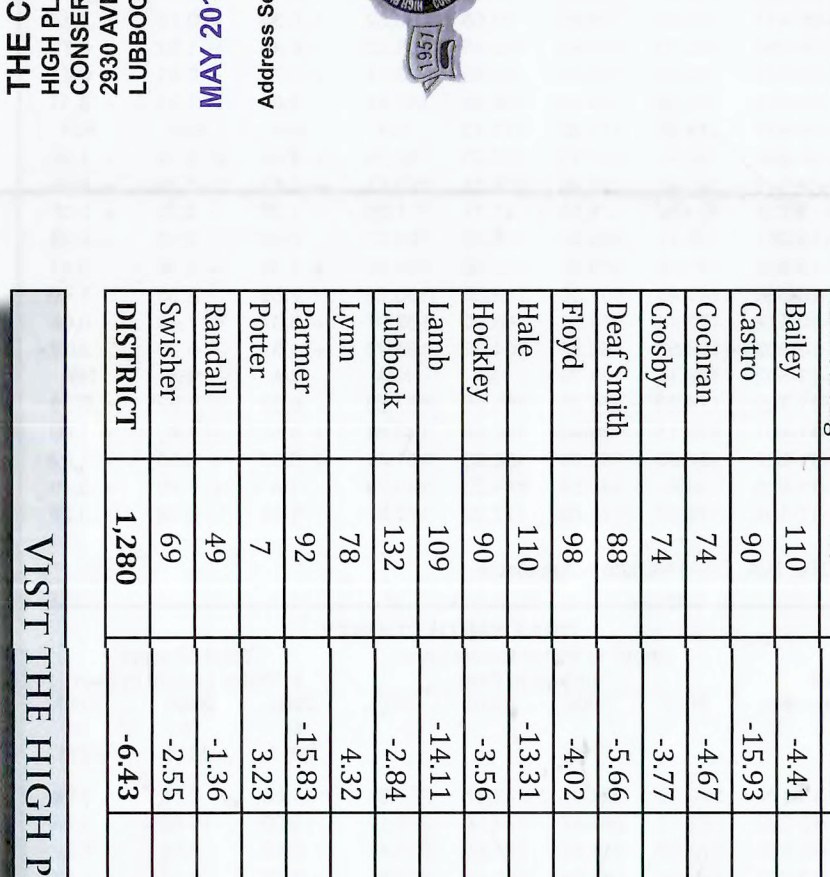

Table for Coahoma County showing well numbers, depths to water below land for years 2001, 2006, 2010, and 2011, and total change.

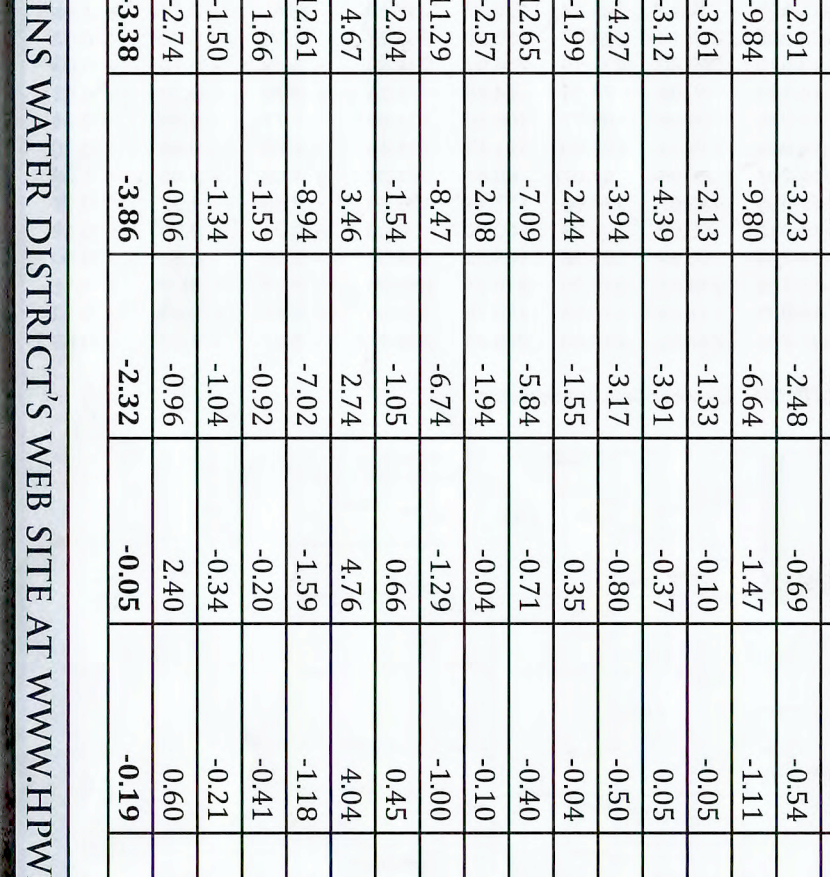

Table for Coahoma County showing well numbers, depths to water below land for years 2001, 2006, 2010, and 2011, and total change.

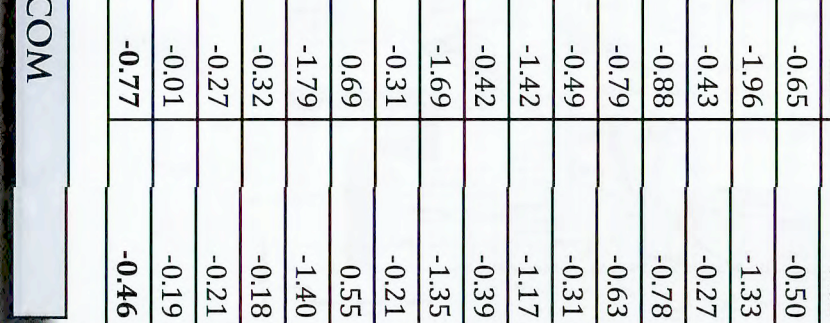

Table for Coahoma County showing well numbers, depths to water below land for years 2001, 2006, 2010, and 2011, and total change.

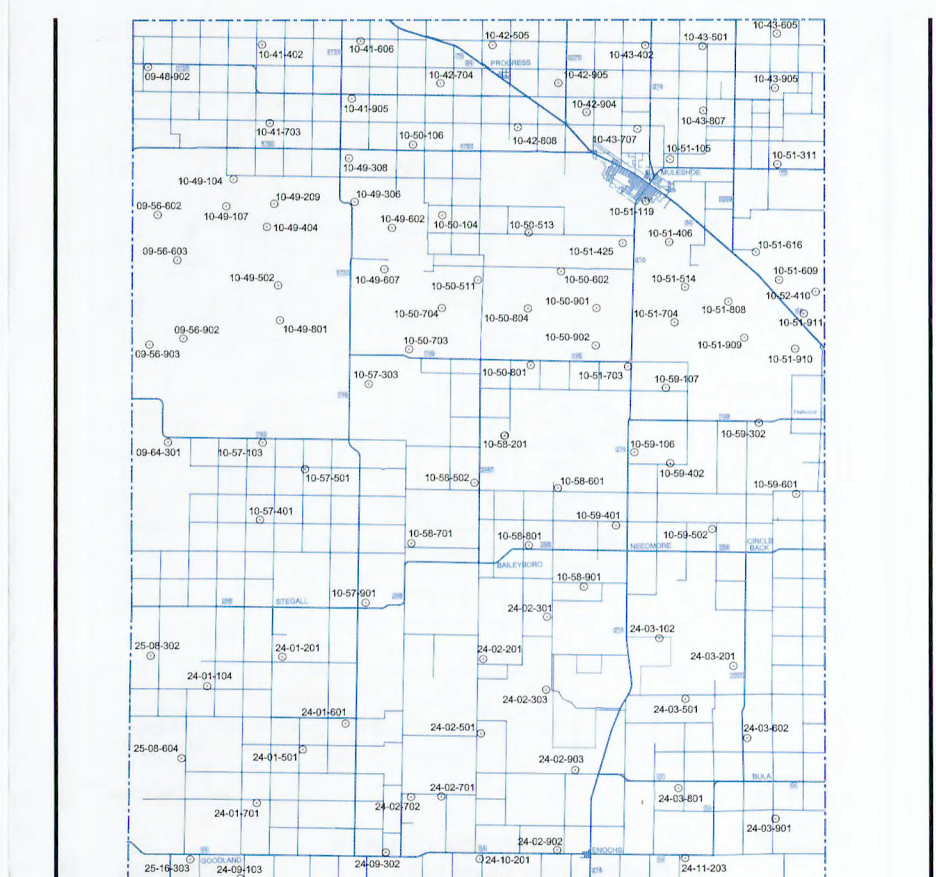

Table for Castro County showing well numbers, depths to water below land for years 2001, 2006, 2010, and 2011, and total change.

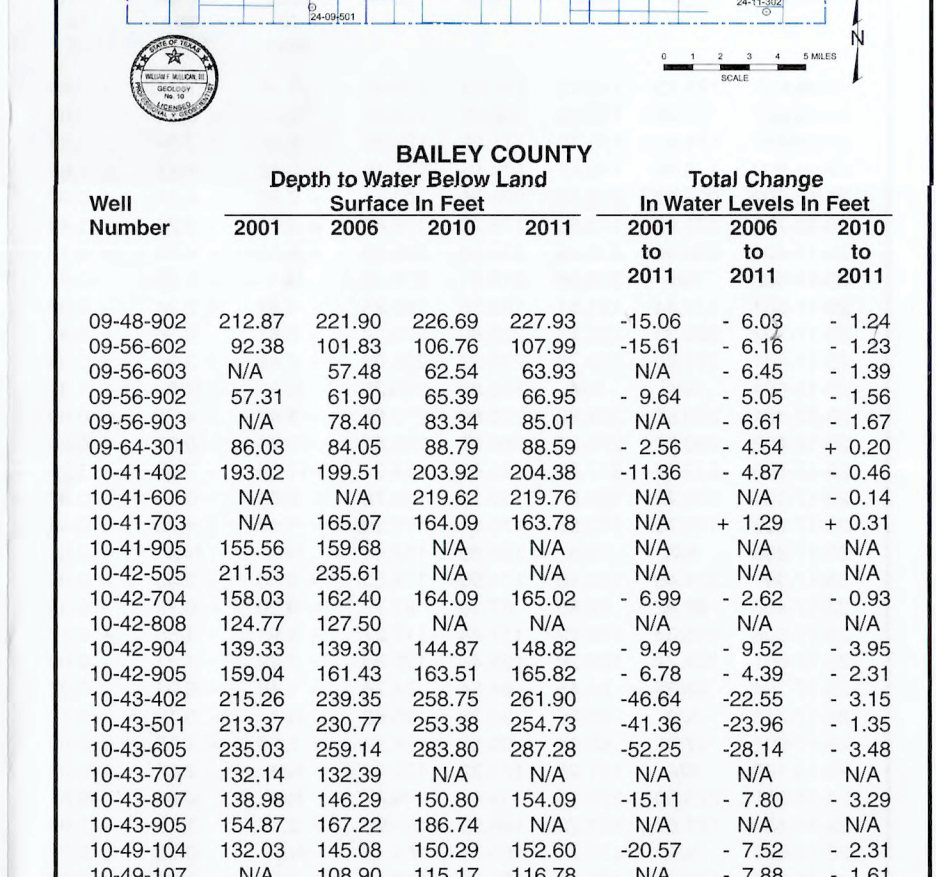

Table for Castro County showing well numbers, depths to water below land for years 2001, 2006, 2010, and 2011, and total change.

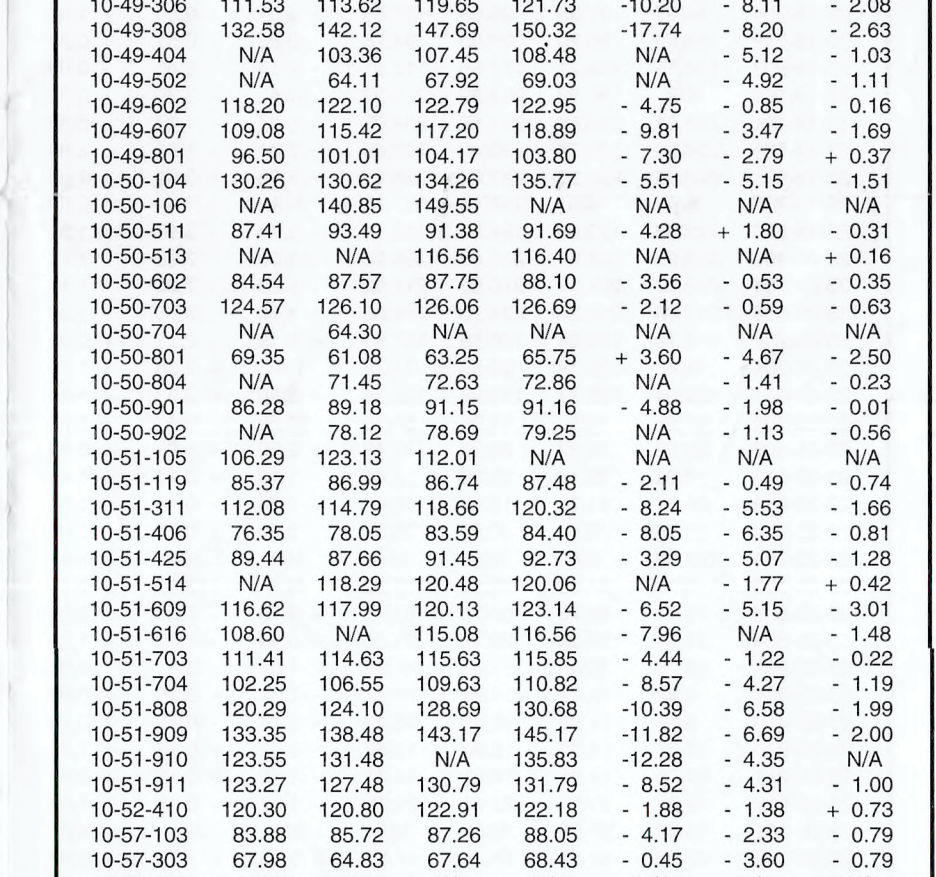

Table for Castro County showing well numbers, depths to water below land for years 2001, 2006, 2010, and 2011, and total change.

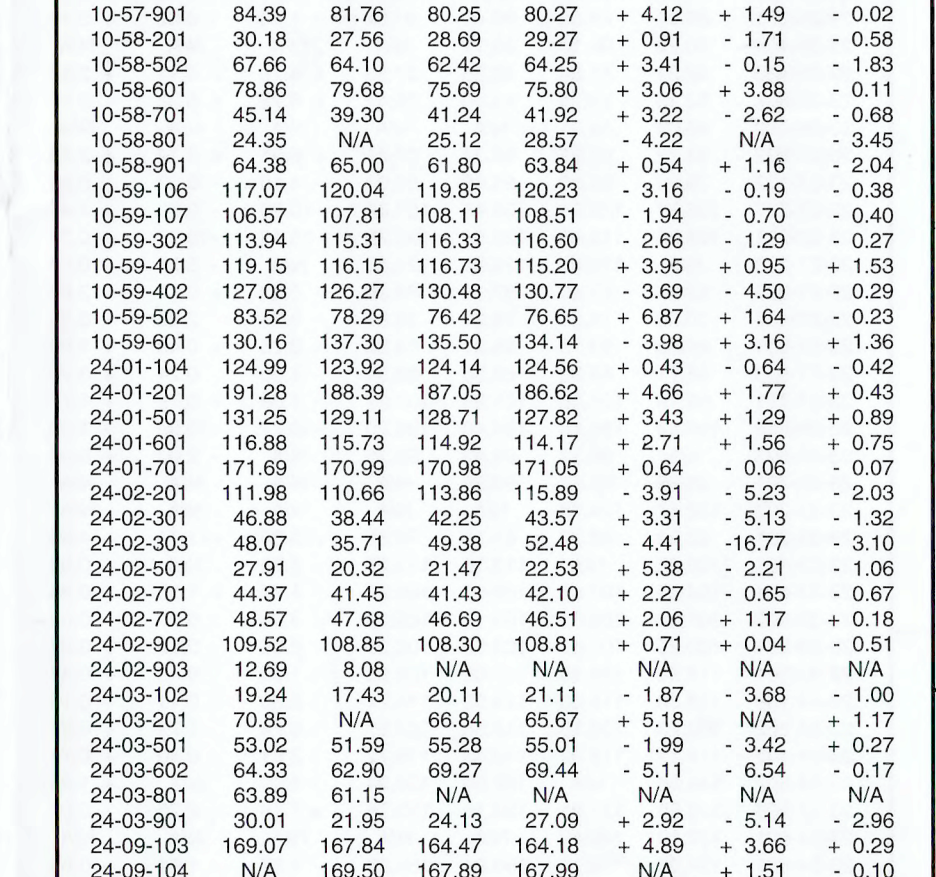

Table for Castro County showing well numbers, depths to water below land for years 2001, 2006, 2010, and 2011, and total change.

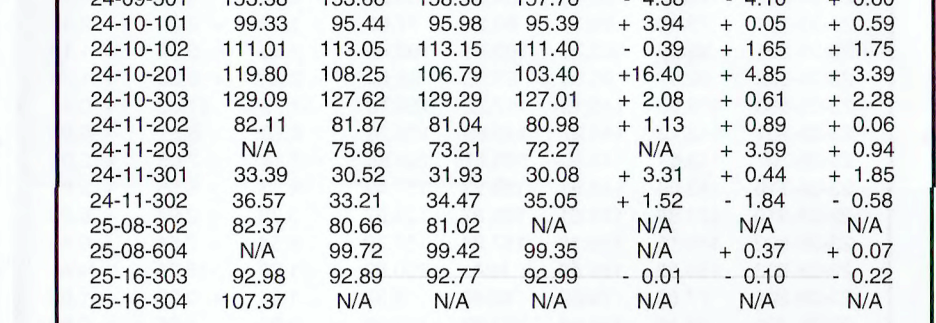

Table for Castro County showing well numbers, depths to water below land for years 2001, 2006, 2010, and 2011, and total change.

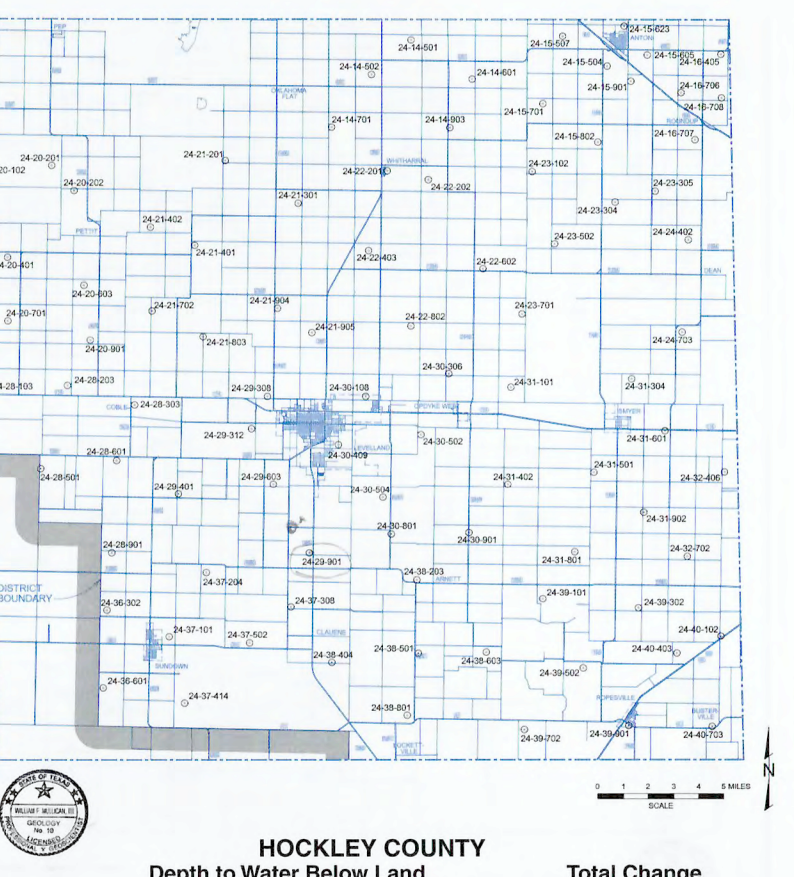

Table for Hockley County showing well numbers, depths to water below land for years 2001, 2006, 2010, and 2011, and total change.



Table for Hockley County showing well numbers, depths to water below land for years 2001, 2006, 2010, and 2011, and total change.



Table for Hockley County showing well numbers, depths to water below land for years 2001, 2006, 2010, and 2011, and total change.

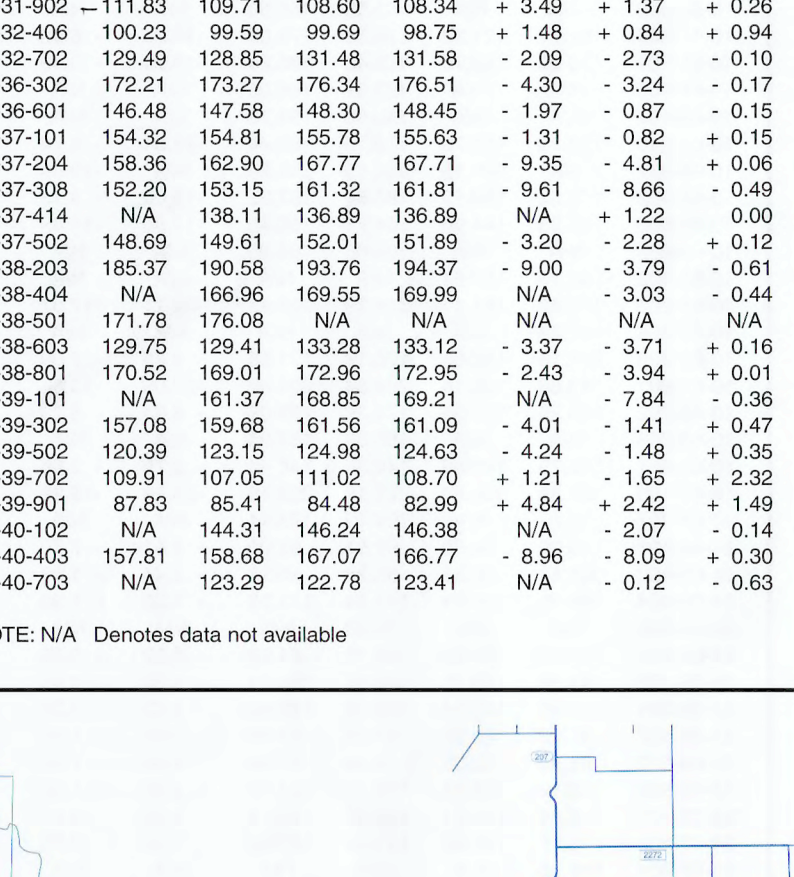

Table for Hockley County showing well numbers, depths to water below land for years 2001, 2006, 2010, and 2011, and total change.

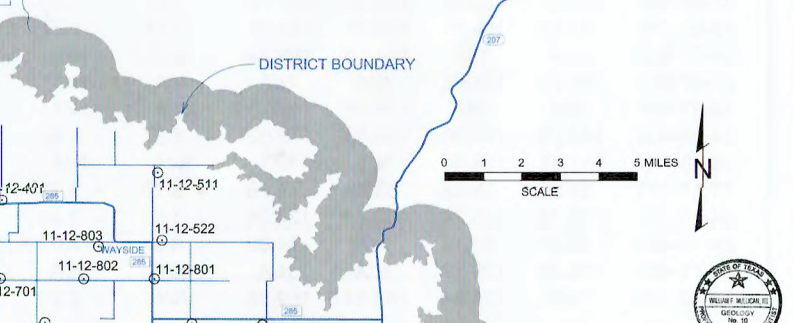

Table for Hockley County showing well numbers, depths to water below land for years 2001, 2006, 2010, and 2011, and total change.

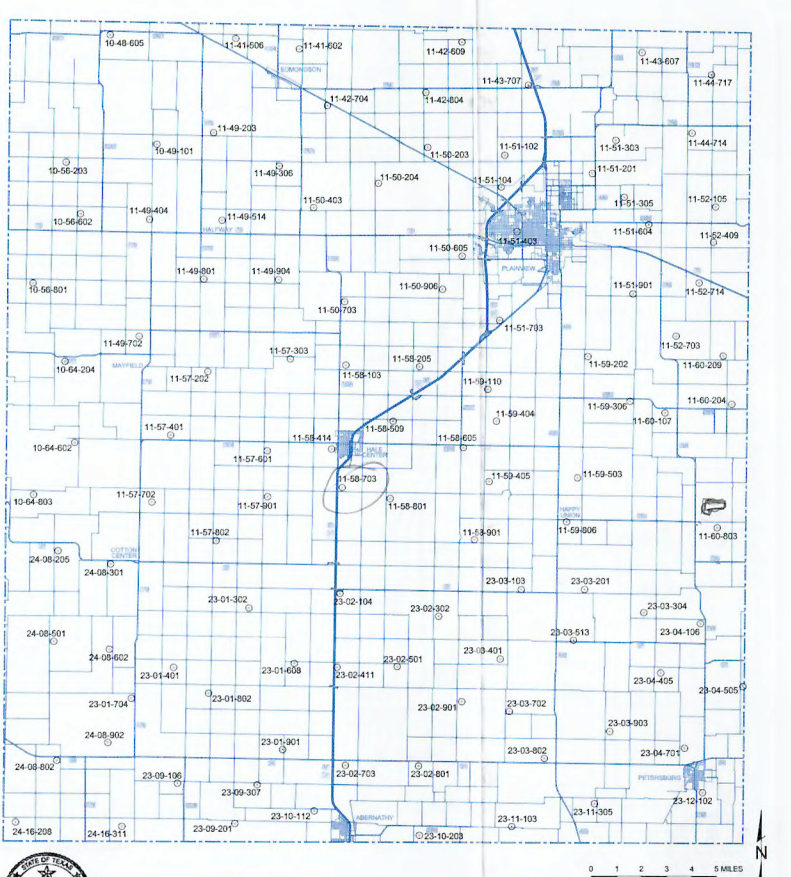

Table for Hale County showing well numbers, depths to water below land for years 2001, 2006, 2010, and 2011, and total change.

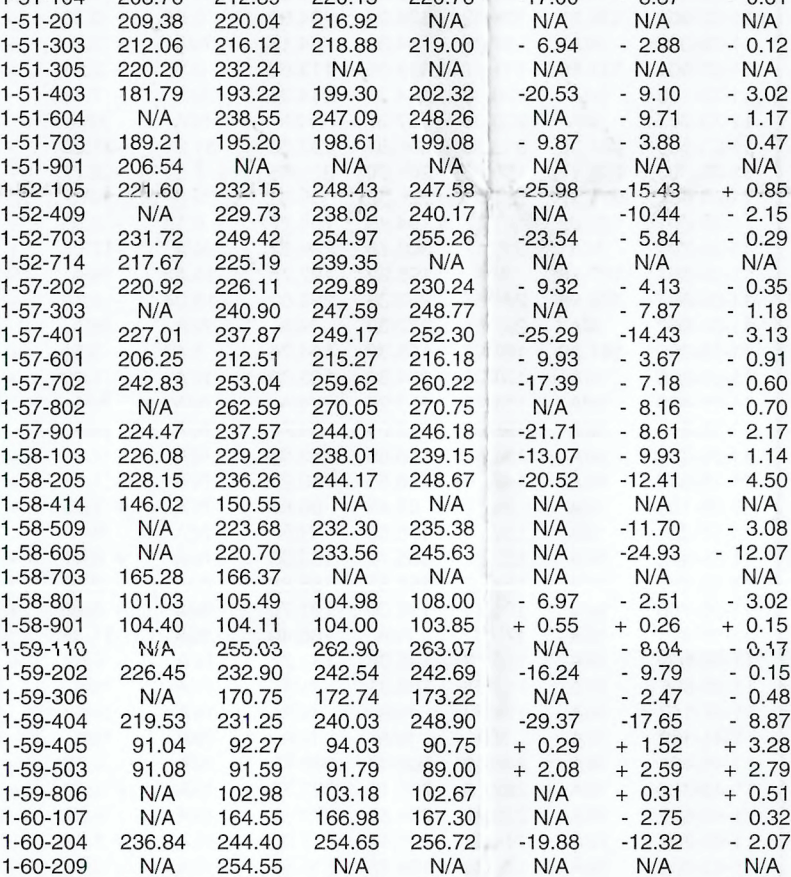

Table for Hale County showing well numbers, depths to water below land for years 2001, 2006, 2010, and 2011, and total change.

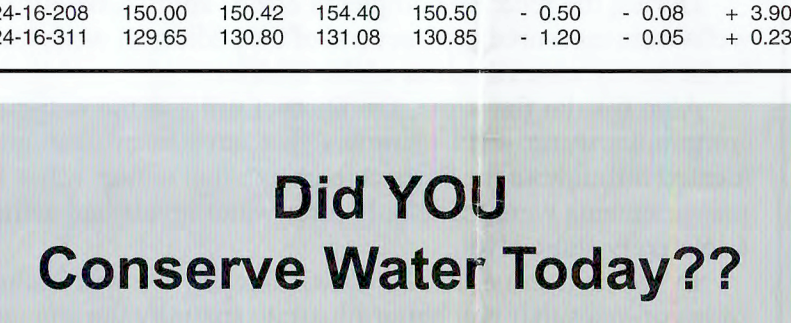

Table for Hale County showing well numbers, depths to water below land for years 2001, 2006, 2010, and 2011, and total change.

Address Service Requested
UNITS 1, 201 W.V.
6662-1944-X
CROSS SECTION
DISTRIBUTION
1280
6-43
-0.05

By William F. Mullen III, P.E.
At this time last year, we were reporting a district-wide average decline of 1.50 feet within the Ogallala Aquifer in the Coahoma County District.
One significant change is that the average annual water level decline in the Ogallala Aquifer based on the 2010-2011 Winter District Report is 1.20 feet.
Since there are several things that have changed in the High Plains Underground Water Conservation District:
- The average annual water level decline in the Ogallala Aquifer based on the 2010-2011 Winter District Report is 1.20 feet.
- The average annual water level decline in the Ogallala Aquifer based on the 2010-2011 Winter District Report is 1.20 feet.
- The average annual water level decline in the Ogallala Aquifer based on the 2010-2011 Winter District Report is 1.20 feet.

THE CROSS SECTION
THERE IS NO SUBSTITUTE FOR WATER
A MONTHLY PUBLICATION OF THE HIGH PLAINS UNDERGROUND WATER CONSERVATION DISTRICT NO. 1, LUBBOCK TX
MAY 2011
DOMESTIC
MUNICIPAL
AGRICULTURAL
CONSERVATION

ARMSTRONG COUNTY
Depth to Water Below Land
Surface In Feet
Total Change
In Water Levels In Feet
2001 to 2011

POTTER COUNTY
Depth to Water Below Land
Surface In Feet
Total Change
In Water Levels In Feet
2001 to 2011

CROSBY COUNTY
Depth to Water Below Land
Surface In Feet
Total Change
In Water Levels In Feet
2001 to 2011

Did You
Conserve Water Today??
06-49-003 204.20 202.28 200.10 199.56 +4.64 +2.72 +0.54
07-55-001 254.90 256.95 255.14 256.04 -3.14 -1.09 +1.00
07-56-007 228.87 229.28 229.41 230.20 -1.33 -0.92 -0.79
23-02-001 229.61 231.98 232.42 232.92 -2.30 -2.20 -2.07
07-56-001 252.05 239.57 240.03 239.29 +1.27 +0.28 +0.74
07-56-011 N/A 253.36 260.01 264.12 N/A -10.76 -11.11
07-56-008 N/A 235.17 233.91 234.32 N/A +0.85 -0.41

